

F Z 4 5 0 D J  
P U R - D  
EDGE BANDING

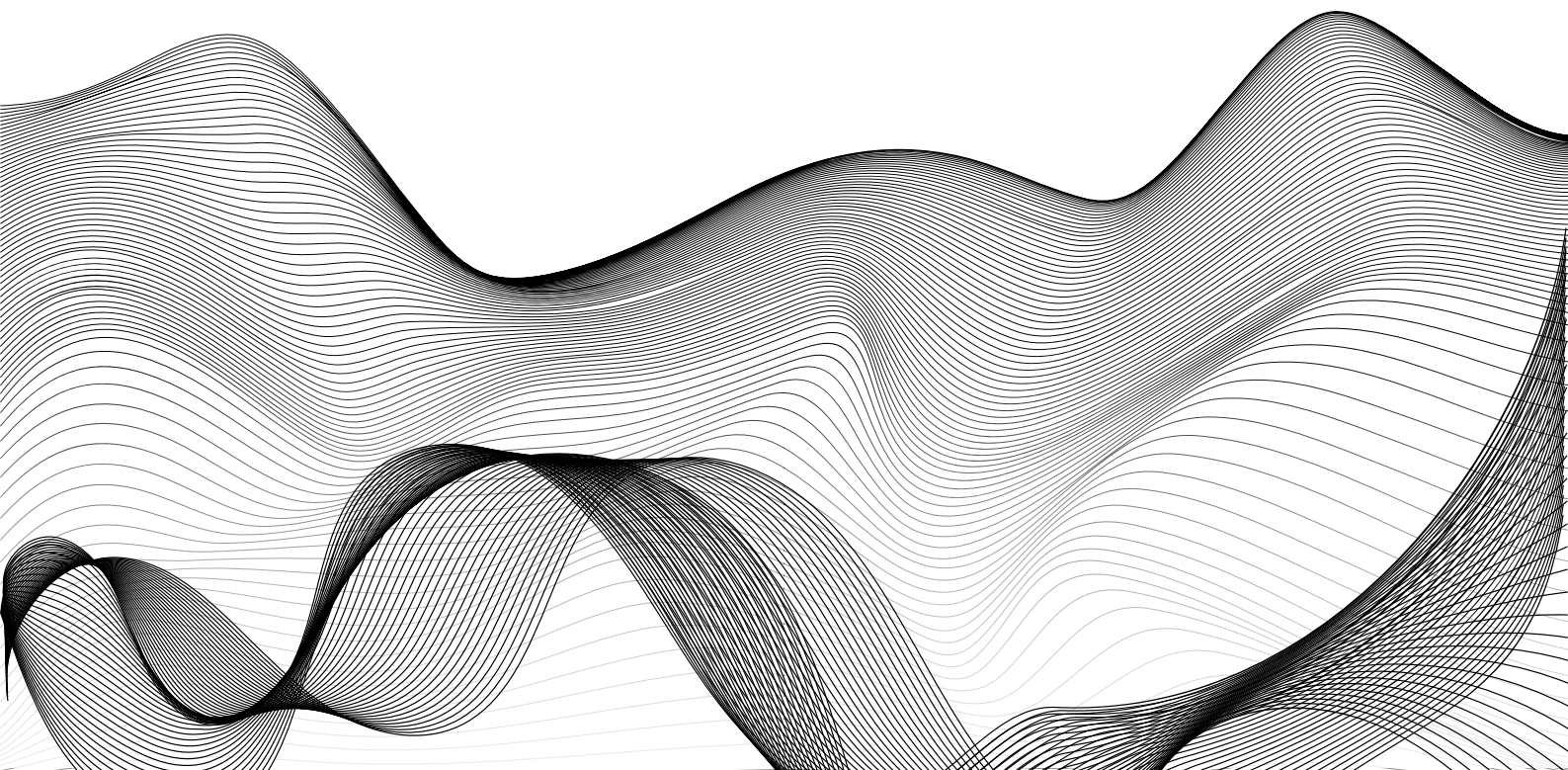

We Simplify and Optimize  
**your Manufacturing**



## **FZ450DJ-PUR-D**

PUR AUTOMATIC EDGE BANDING MACHINE WITH SIDE DRILLING

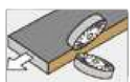

Buffing



Side  
drilling



Scraping

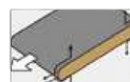

Corner  
trimming



Fine  
trimming

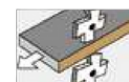

Rough  
trimming

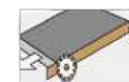

End  
trimming



Gluing

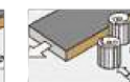

Pre-milling

**WOTSO Group**  
Carretera de Vigo,74  
32001 Ourense - Espanha

[www.wotso.eu](http://www.wotso.eu)  
[geral@wotso.eu](mailto:geral@wotso.eu)

MODEL	FZ450DJ-PUR-D
Machine dimension	9600*950*1850mm
Power	30kW
Panel thickness	10-60mm
Panel width	60mm
Feeding speed	15-23m/min
Working pressure	0.6Mpa
Edge thickness	0.4-3mm
Weight	2800kg

COMPONENTS	BRAND
Inverter	Delta
PLC	Delta
Touch screen	Smart Touch screen
Air switch	Siemens
Contactora	Siemens
Intermediate relay	Schneider
Travel switch	Honeywell(USA) Schneider (German)
Switch button	Siemens
High-speed motor	Rundawords
Pneumatic components	AirTAC

## Warranty

WOTSO offers a 12-month warranty for service issues that are not caused by operator errors. Service and support are available throughout the lifetime of a machine at fair and reasonable costs after the warranty term. All parts within the warranty are provided by the seller.

Hot-quick melt + PUR Unit



Beam gantry with roller pressure system



Pre milling



Pressing Rollers



End Trimming



Rough/ Fine Trimming

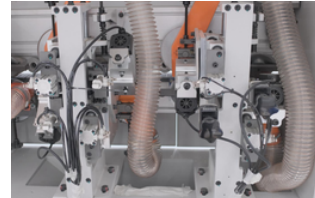

Flat scraping



Corner Rounding



Buffing unit



Auto lubrication



## Optionals available:

Upgrade to 65mm height pre-milling cutter

PUR System for 20KGS deposit / PUR 2kg incorporated

Add 4-Tape magazines for automatically change

Bottom or Side Grooving

All roller return system

All belt return system

# *We Simplify and Optimize* Your Manufacturing

We Strive to Make Your Production **Smarter**,  
**Faster** and More **Cost-efficient** with minimum human labor required.